

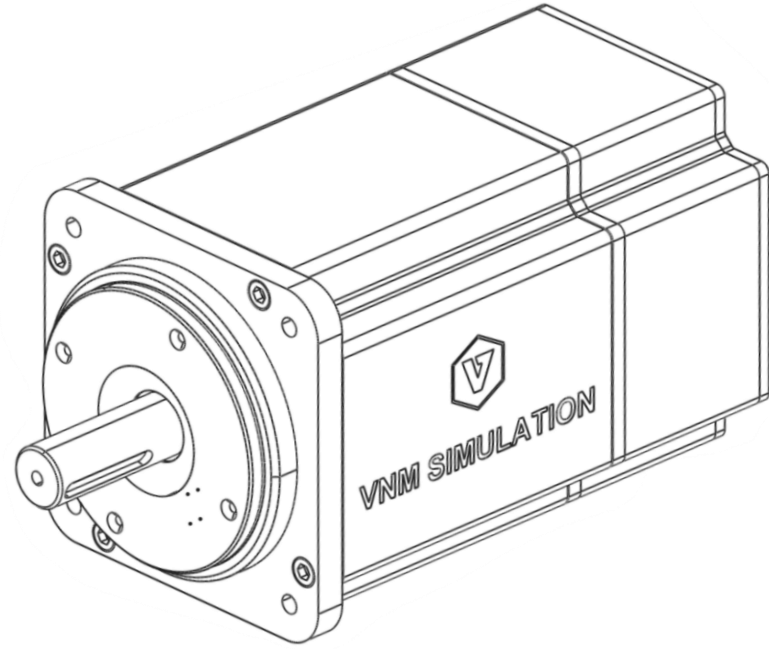

Quick installation guide VNM DD Slipping V1

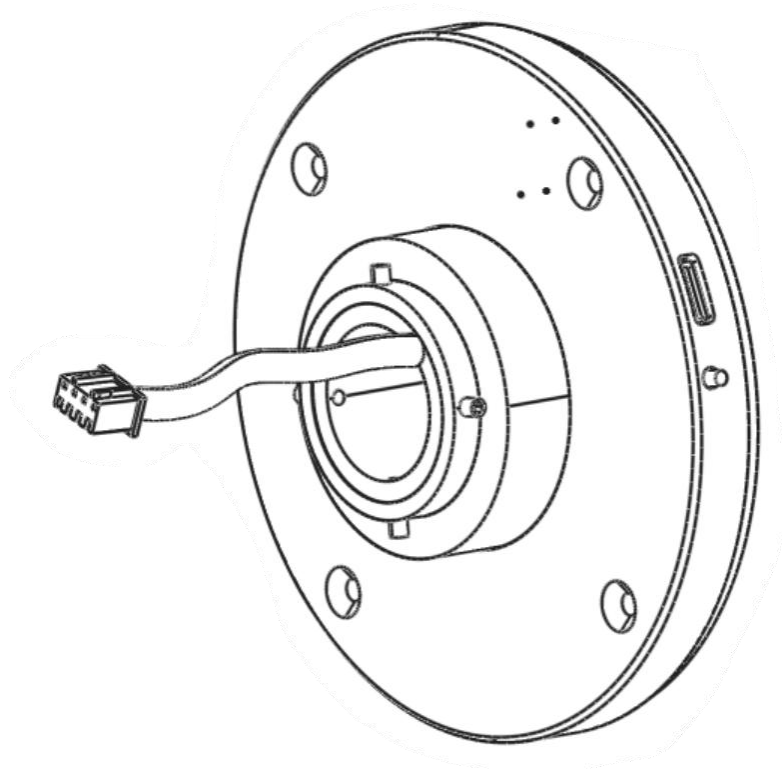

1

Direct Drive VNM
x1
(not included)

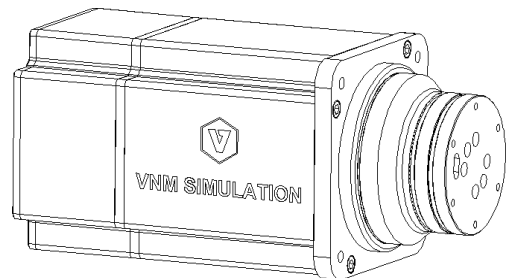

2

VNM QR Base Side
x1
(not included)

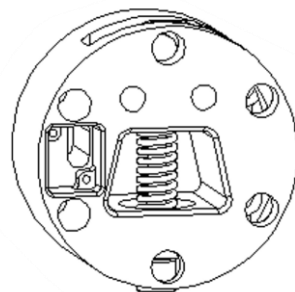

3

VNM Slipping V1
x1

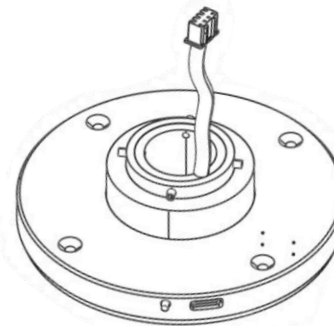

4

Extension Block
x1

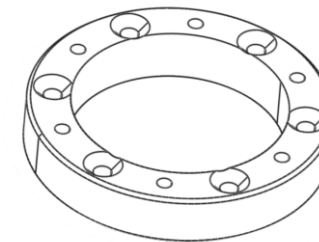

5

Gx12 to PH2.0 Cable for Legacy GT
Wheel without XH2.54 header
x1

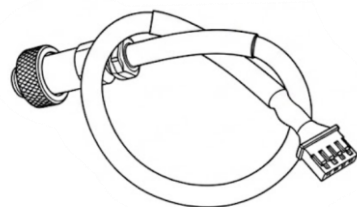

6

XH2.54 to PH2.0 Cable
for VNM Wheels
x1

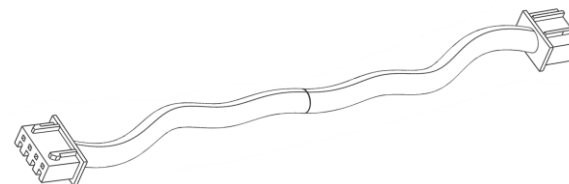

*If you are missing any parts, please contact our
customer support team who can assist!*

7

Wheel side PCB set

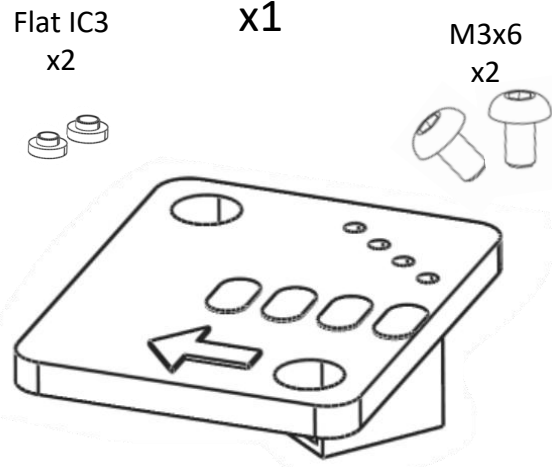

8

Base side PCB set

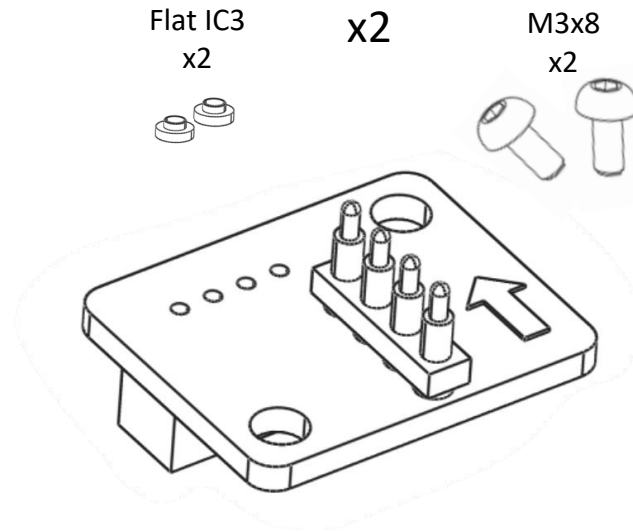

9

Shaft Spacer & Flat head

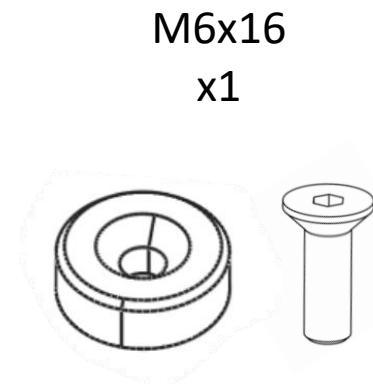

10

QR Wheel Side

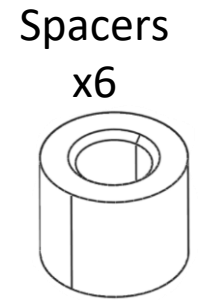

M4x20 x2



Flat head M3x16 x4



Flat head M5x20 x6



M5x30, Springs, Washers, Nuts x6

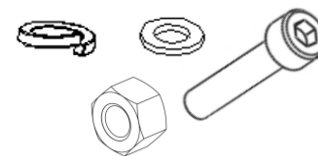

Hex keys 1/16 inch, 1.5mm

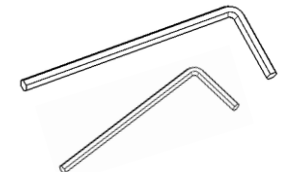

If you are missing any parts, please contact our customer support team who can assist!

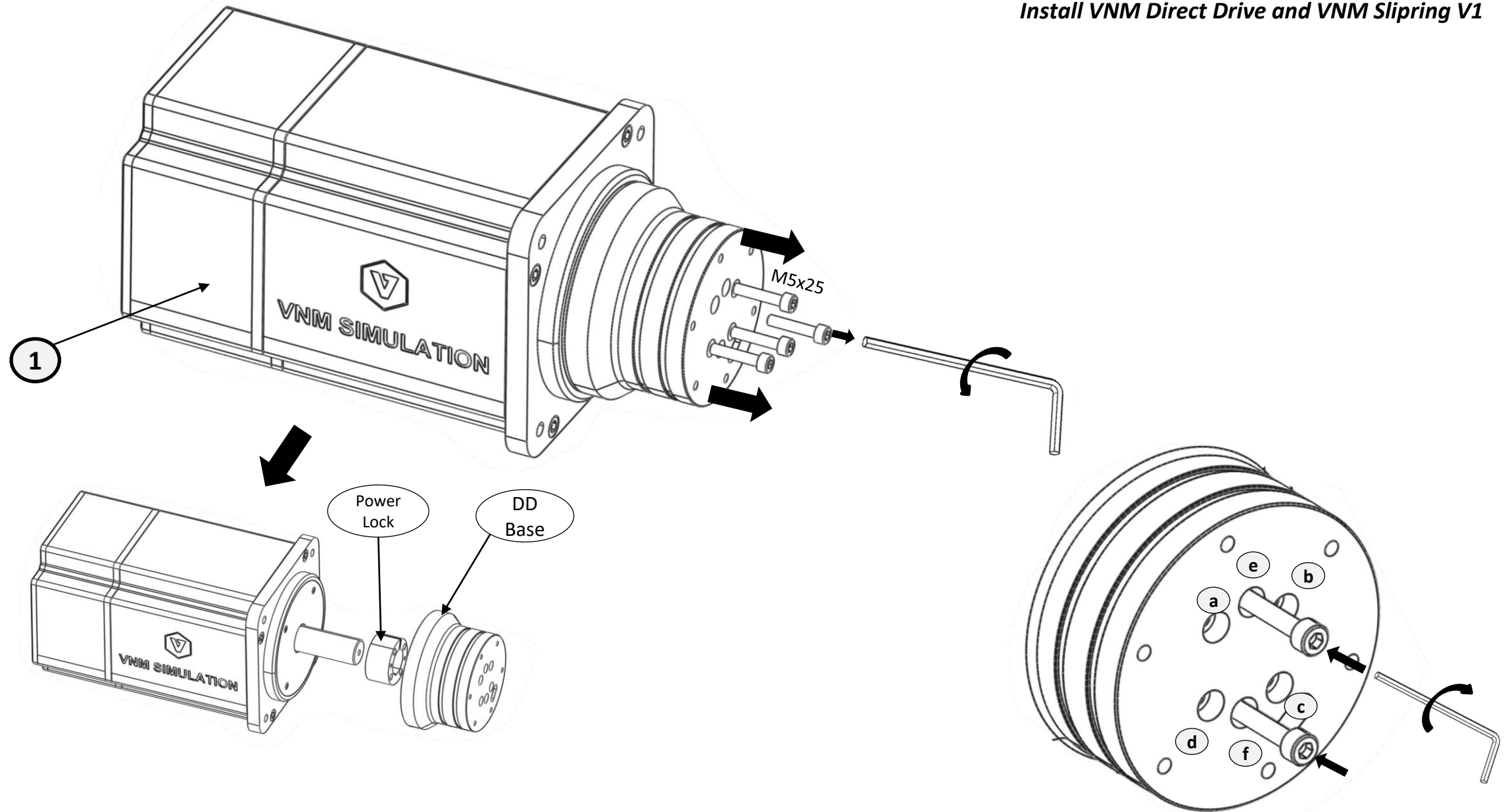

Tip: After removing the four M5x25 screws from positions **a**, **b**, **c**, and **d**, install and gradually tighten two M5x25 screws into positions **e** and **f** to release and remove the DD Base block.

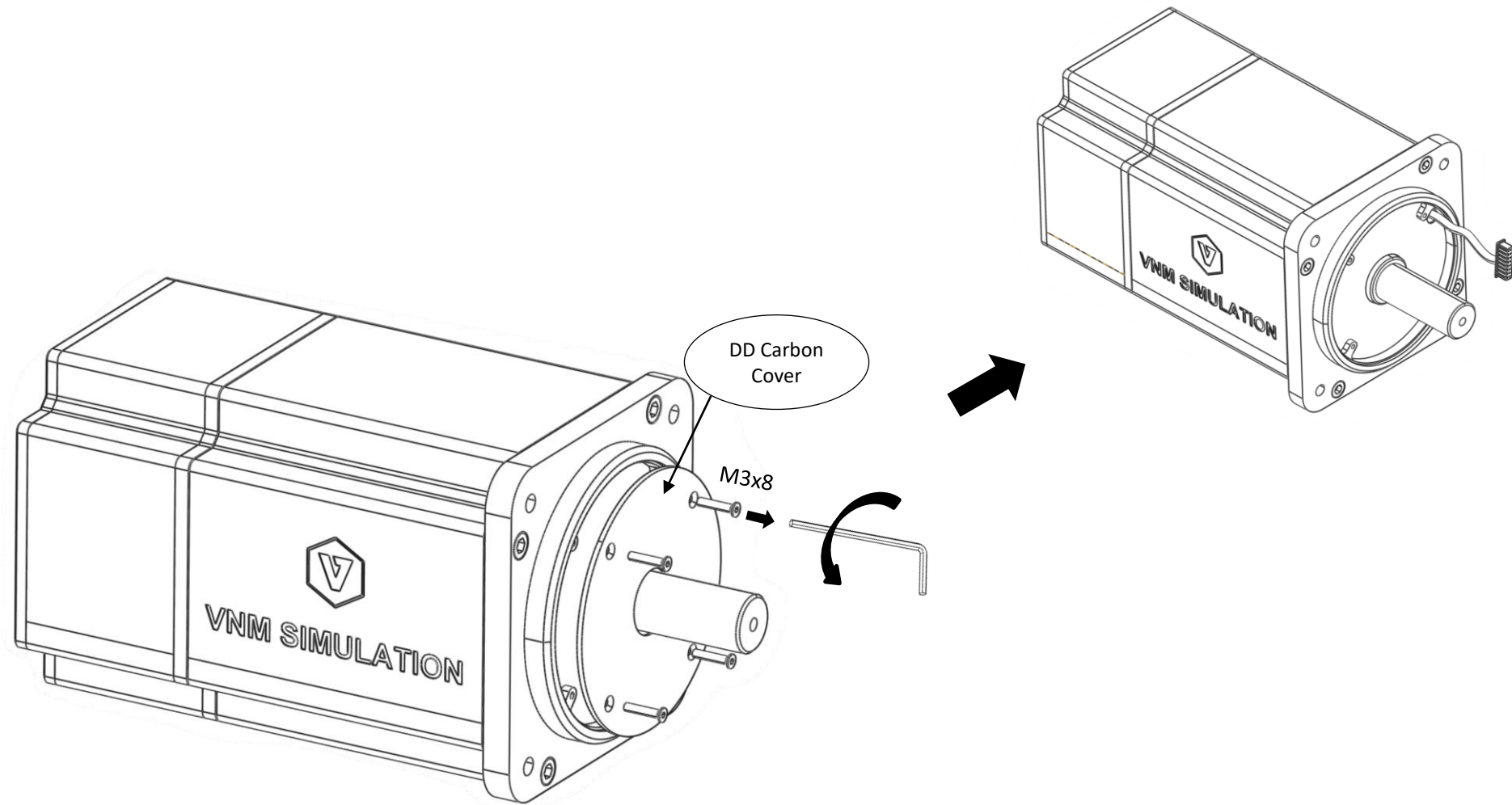

Install VNM Direct Drive and VNM Slipping V1
(For VNM DD Premier, Supreme, Elite & Xtreme Serial from 201)

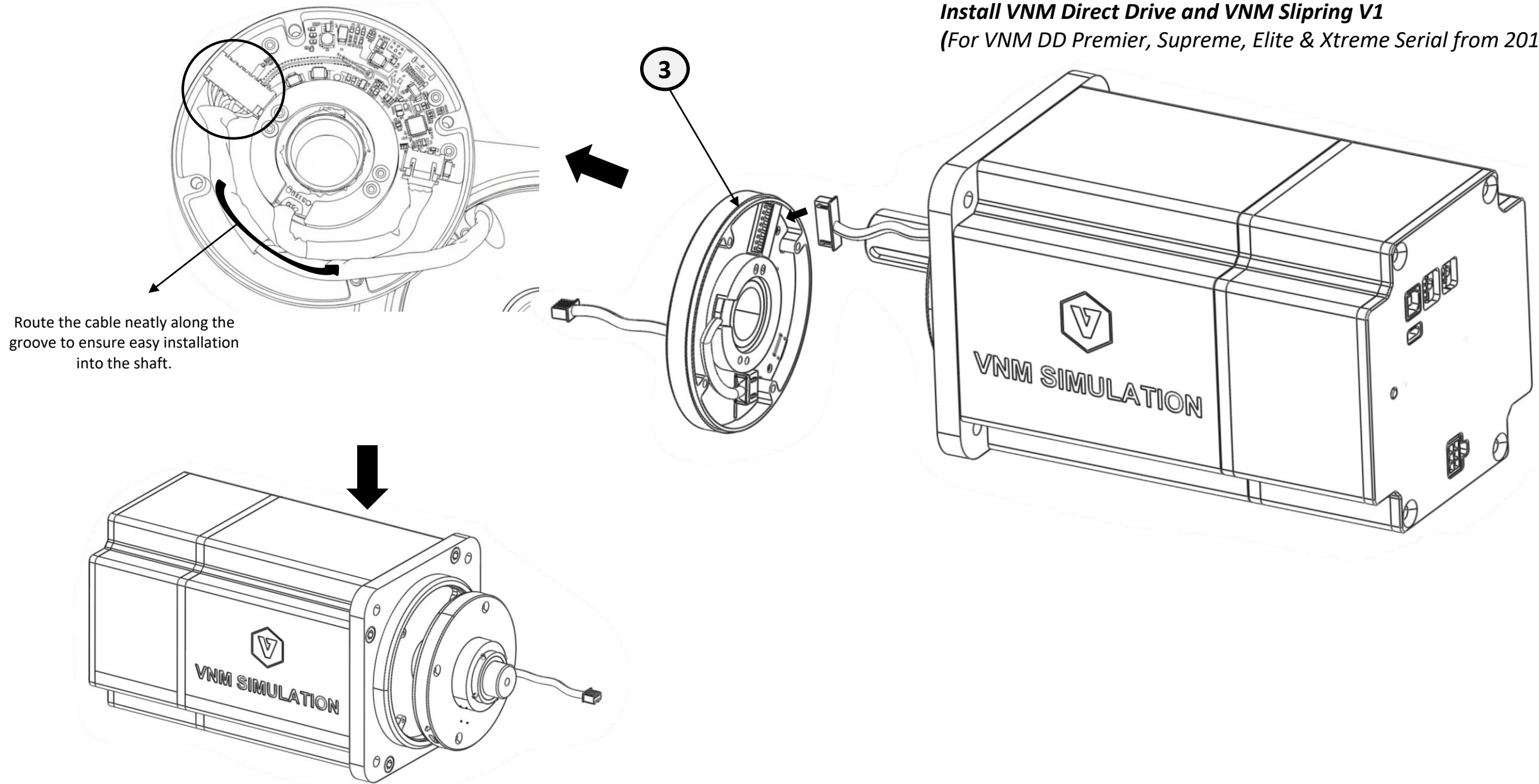

Route the cable neatly along the groove to ensure easy installation into the shaft.

On the VNM DD housing, connect the 8-pin header cable to the port on the VNM Slipping V1 PCB.

Disclaimer: If you encounter difficulty removing the VNM Slipping at this step for adjustment, please refer to the tip on the last page of this guide.

Flat head M3x16
x4



Shaft Spacer & Flat head M6x16
x1

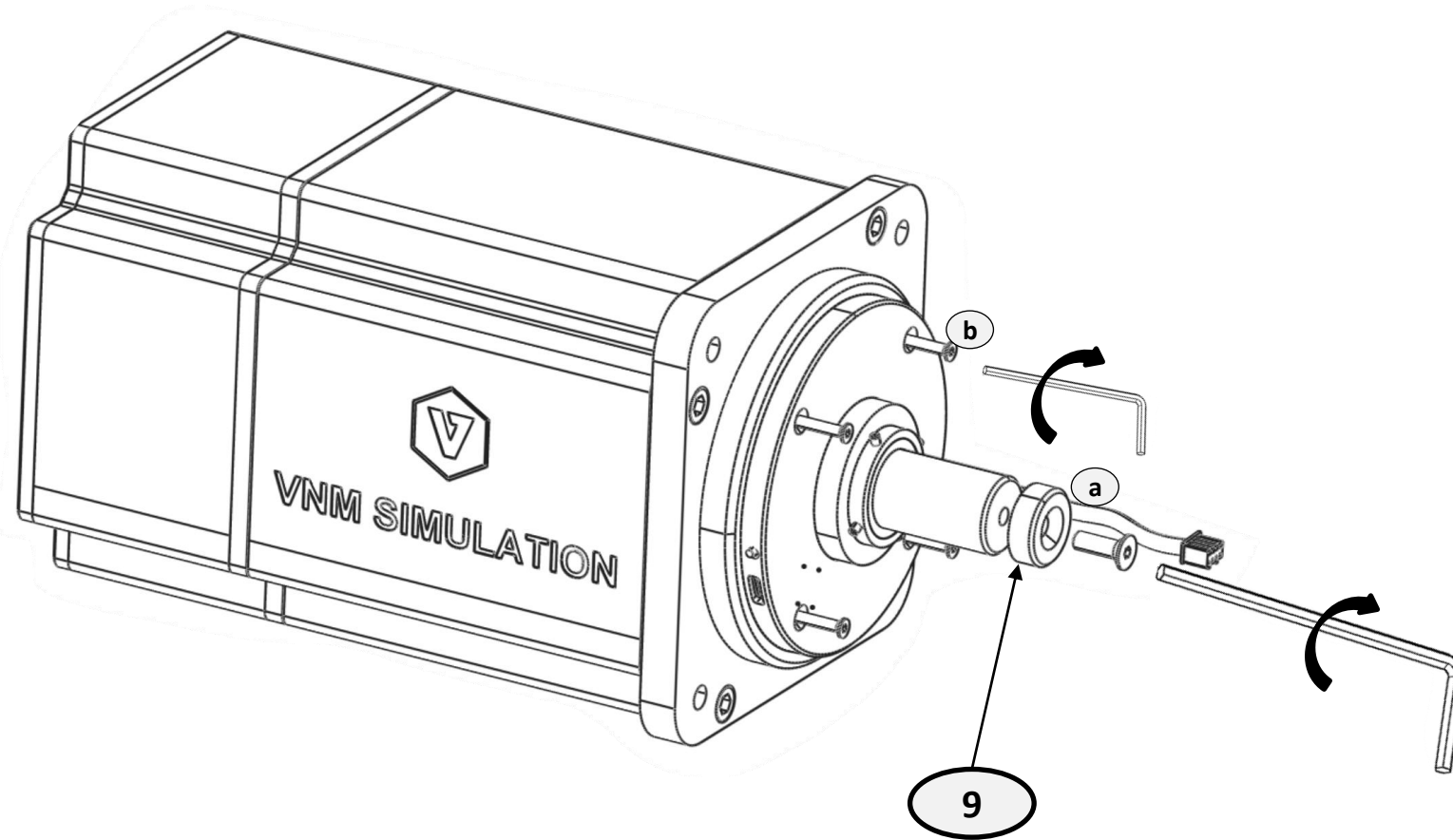

Tighten positions a, b sequentially using a hex key.

Hex keys 1/16
inch, 1.5mm

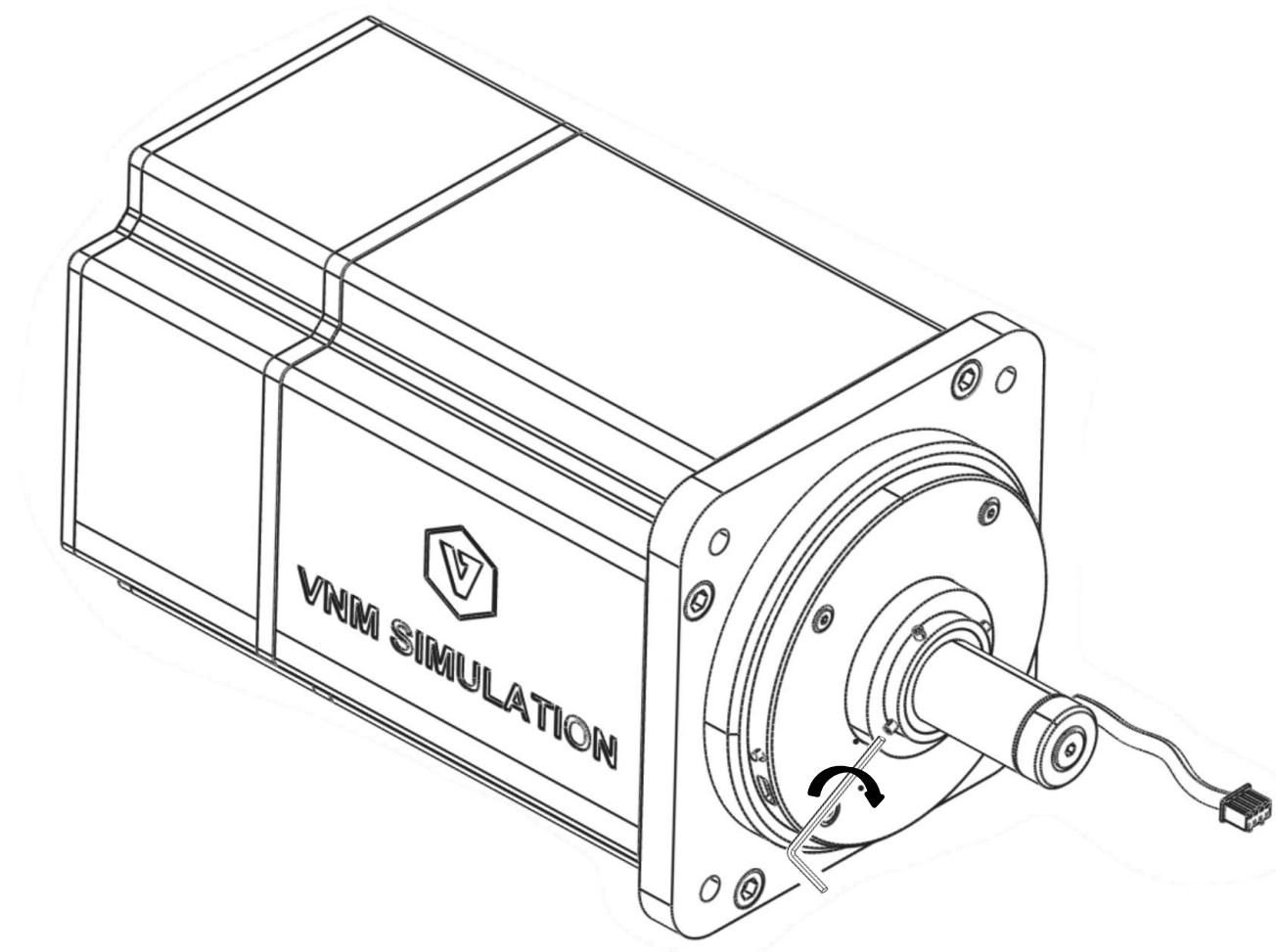

Secure the M3 set screw on the VNM Slipping using a 1/16 or 1.5 mm hex key. Do not overtighten, as this may damage the VNM Slipping

M5x25
x4

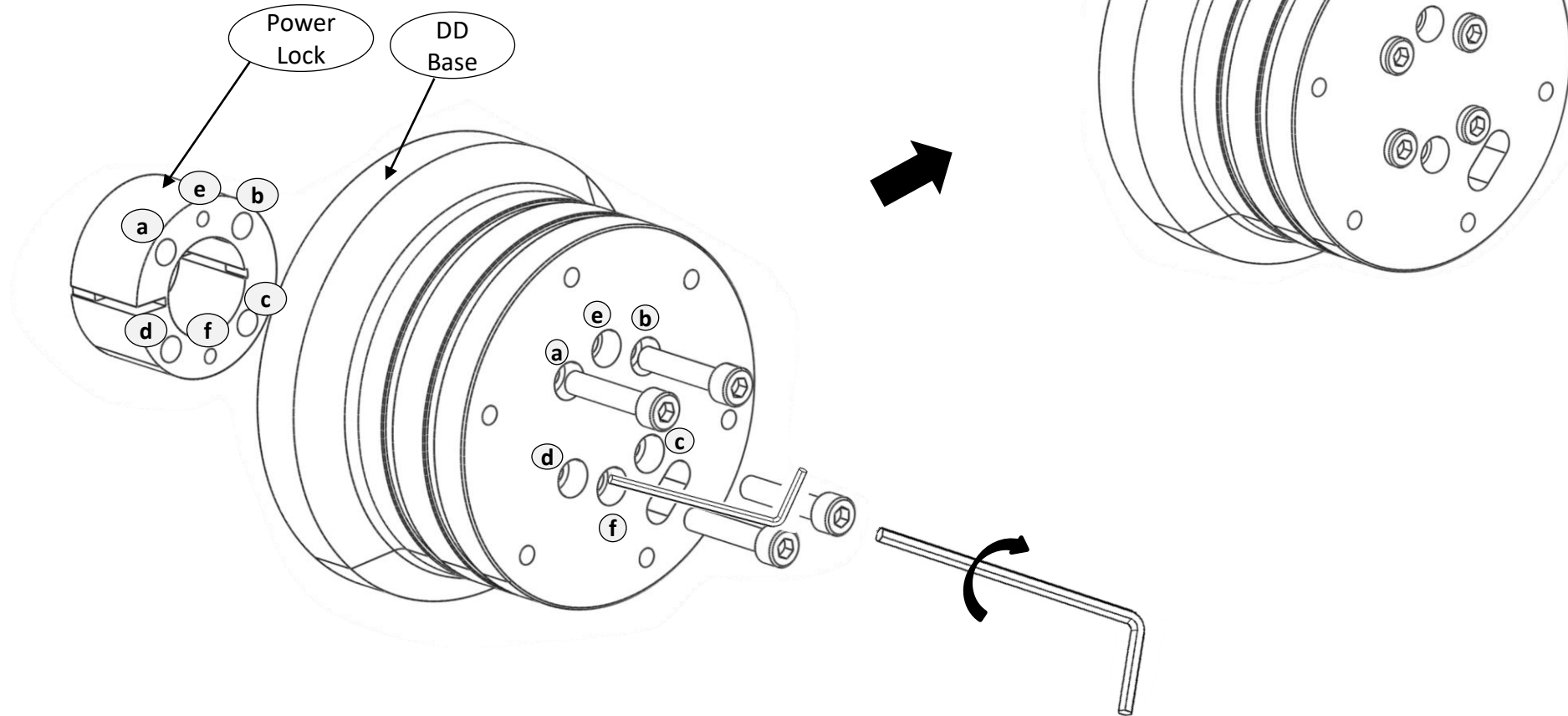

Tip: Use a small hex key to align positions **e** and **f**. Then install the four M5x25 screws symmetrically at positions **a-c** and **b-d**. This keeps the power lock positioned inside the DD Base. **Do not fully tighten** the screws at this step

Install VNM Direct Drive and DD Base

M5x25
x4

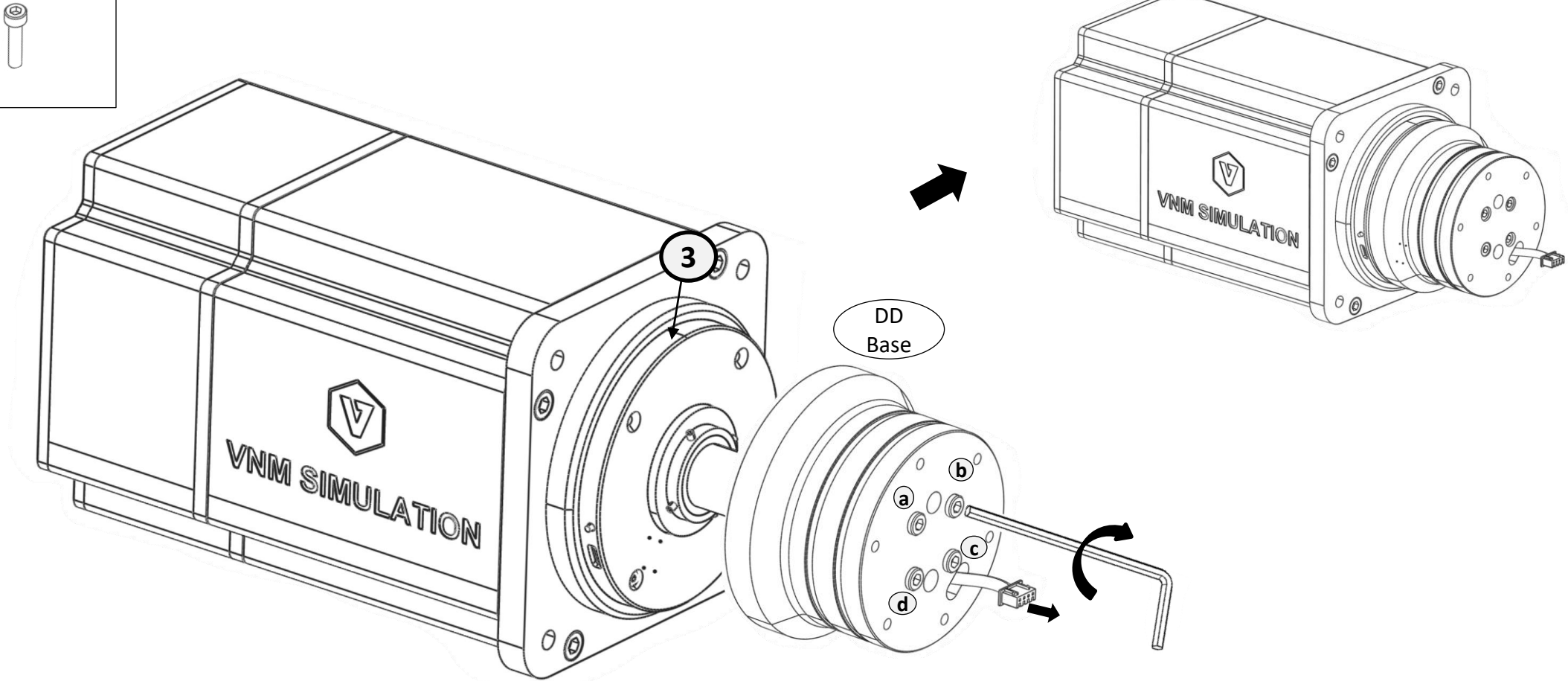

Slowly install the DD Base block (with power lock installed) onto the VNM DD shaft while routing the Slipping 4-pin header cable (part No. 3) through the DD Base hole. Then **fully tighten** the four M5x25 screws symmetrically at positions **a-c** and **b-d**.

CAUTION: Carefully and evenly tighten positions a-c and b-d. Insufficient tightening torque will cause the DD to lose center alignment / go off-center during high-torque operation.

Flat Header M5x20
x6



Extension Block
x1

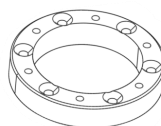

Install VNM Direct Drive and Extension block

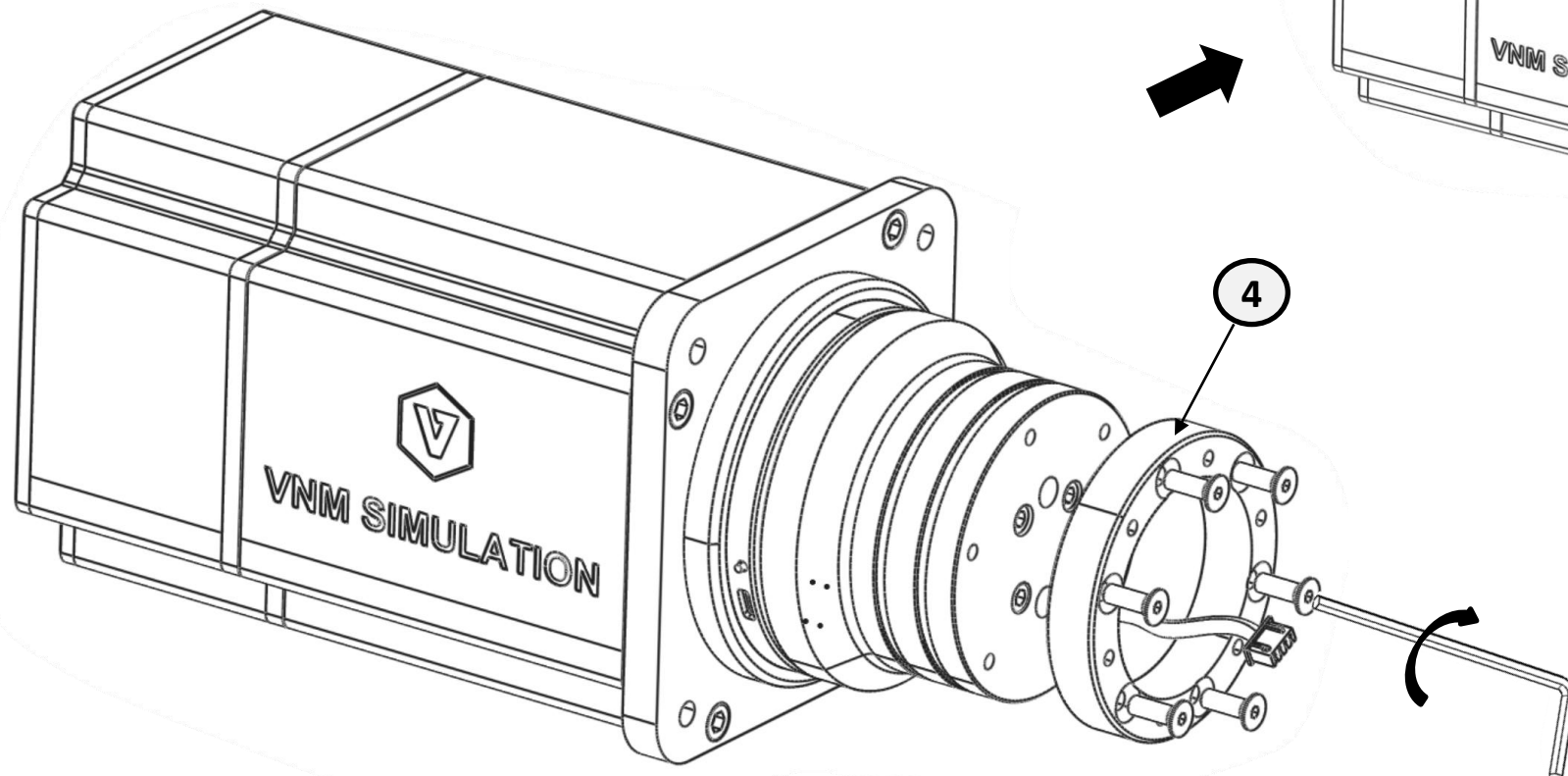
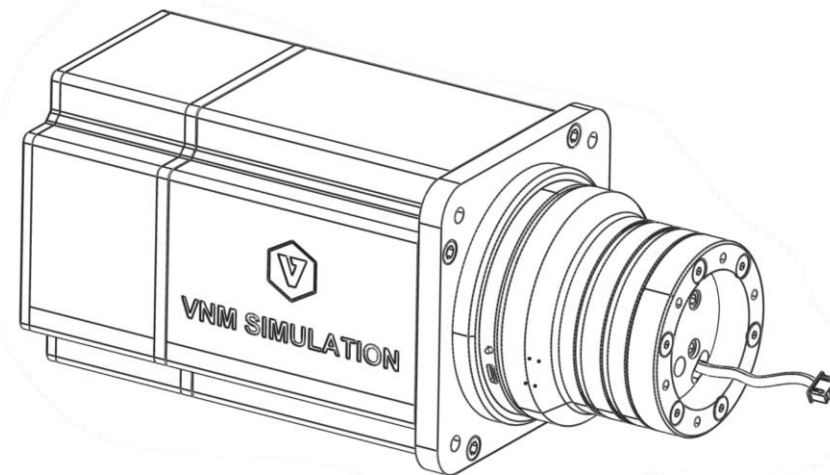

Tighten the six M5x20 flat head screws.

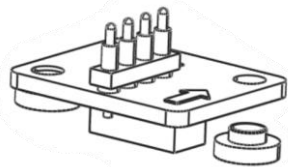
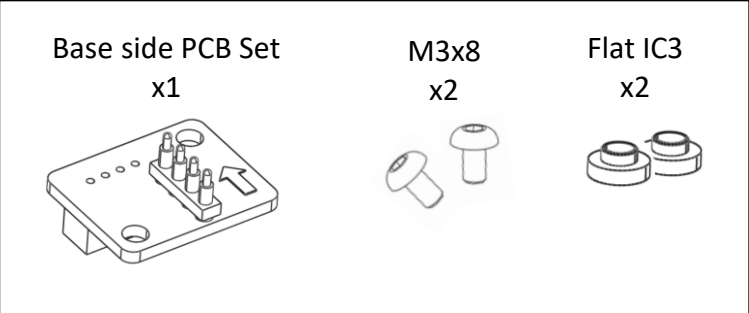

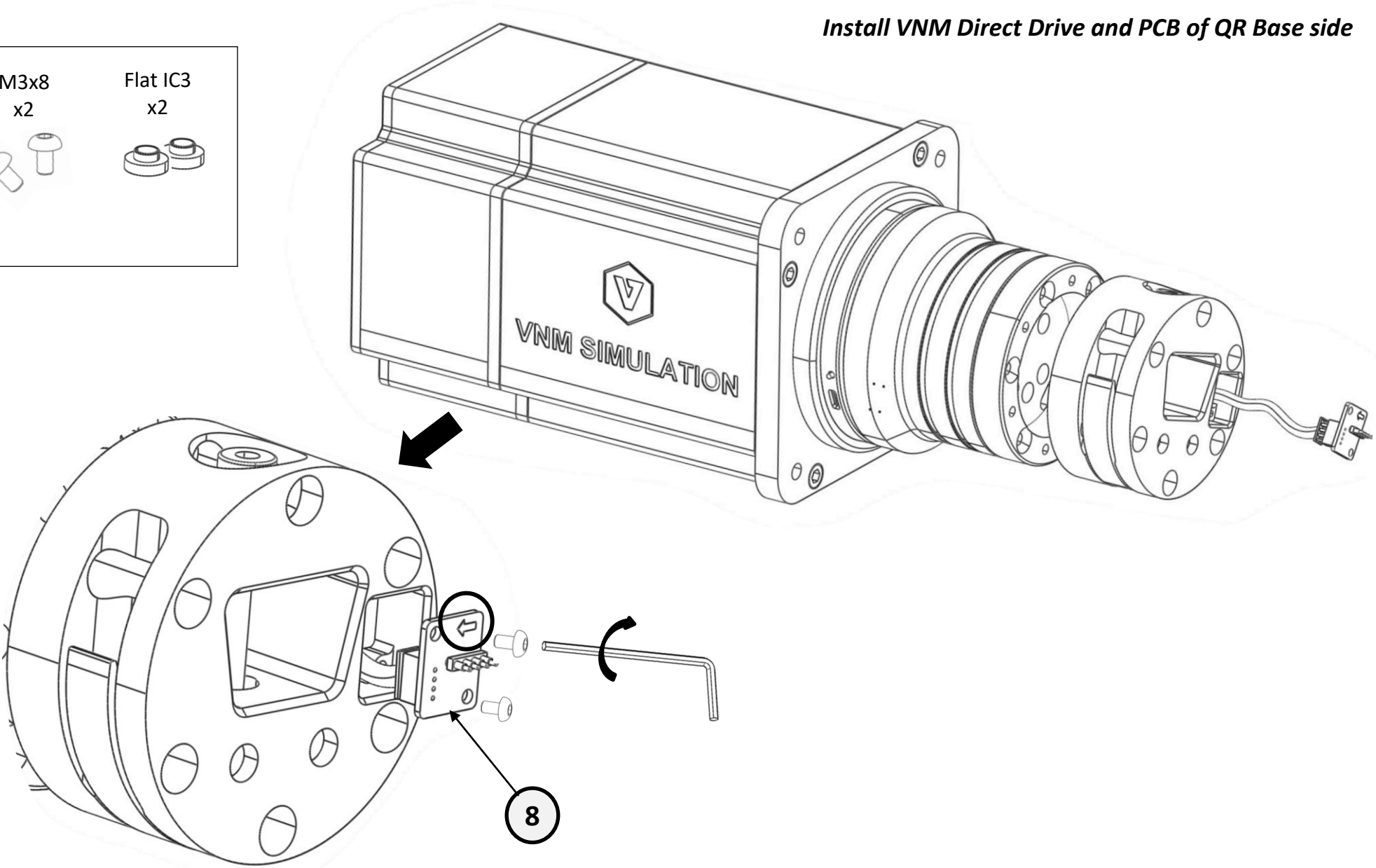

Manually press the IC3 plastic spacer into the PCB from the side without the arrow marking.



Tip: Connect the exposed PH2.0 slirping header to the QR Base side PCB, then tighten the two M3x8 screws to a moderate torque. Ensure **the arrow** on the PCB points **toward the center** of the DD.

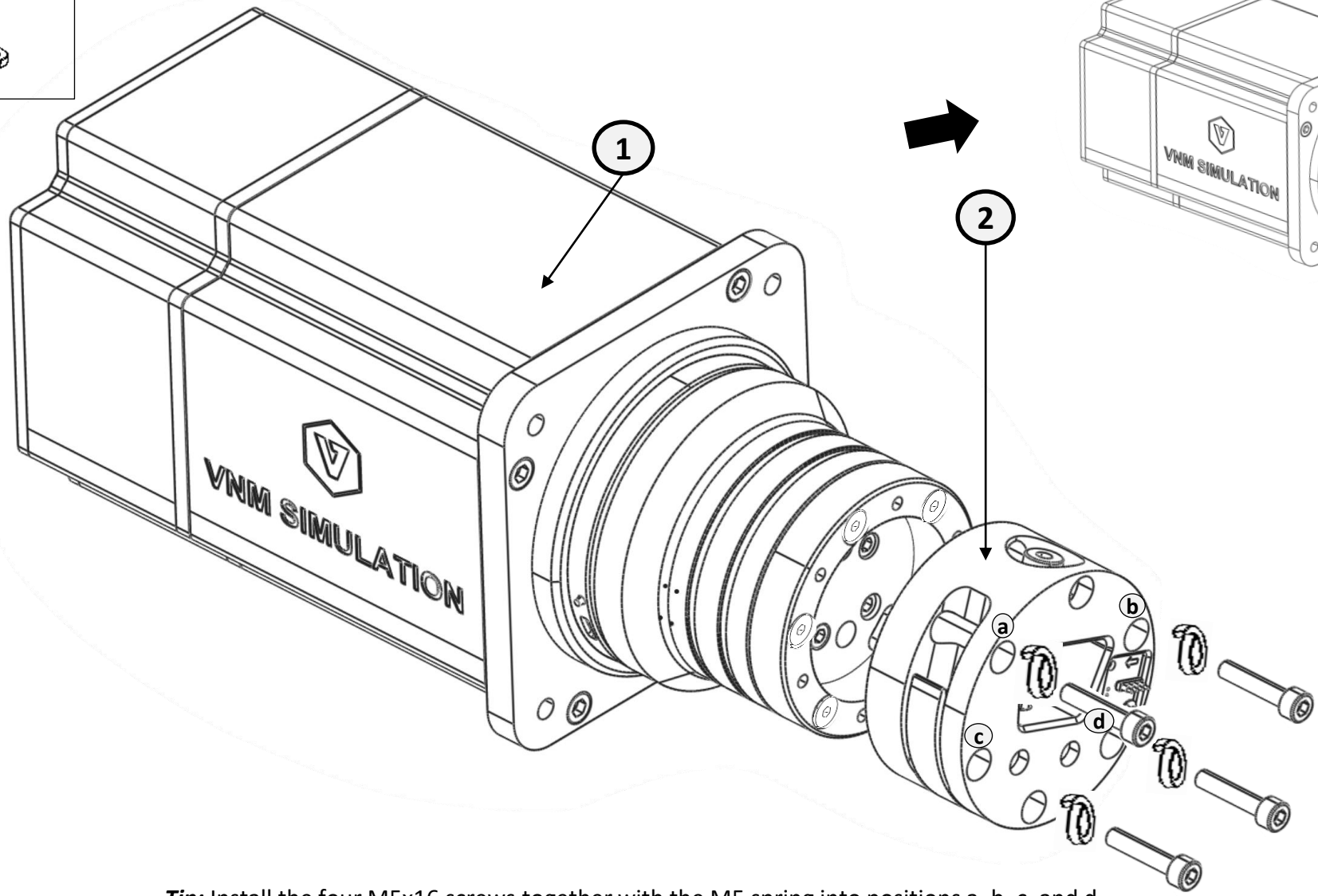

**Install VNM Direct Drive and VNM QR Base side
(Method 1)**

M5x16 x4	Spring M5 x4
	

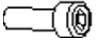

Tip: Install the four M5x16 screws together with the M5 spring into positions a, b, c, and d.
Then fully tighten them.

**Install VNM Direct Drive and VNM QR Base side
(Method 2)**

M5x16 x6	Spring M5 x6
	

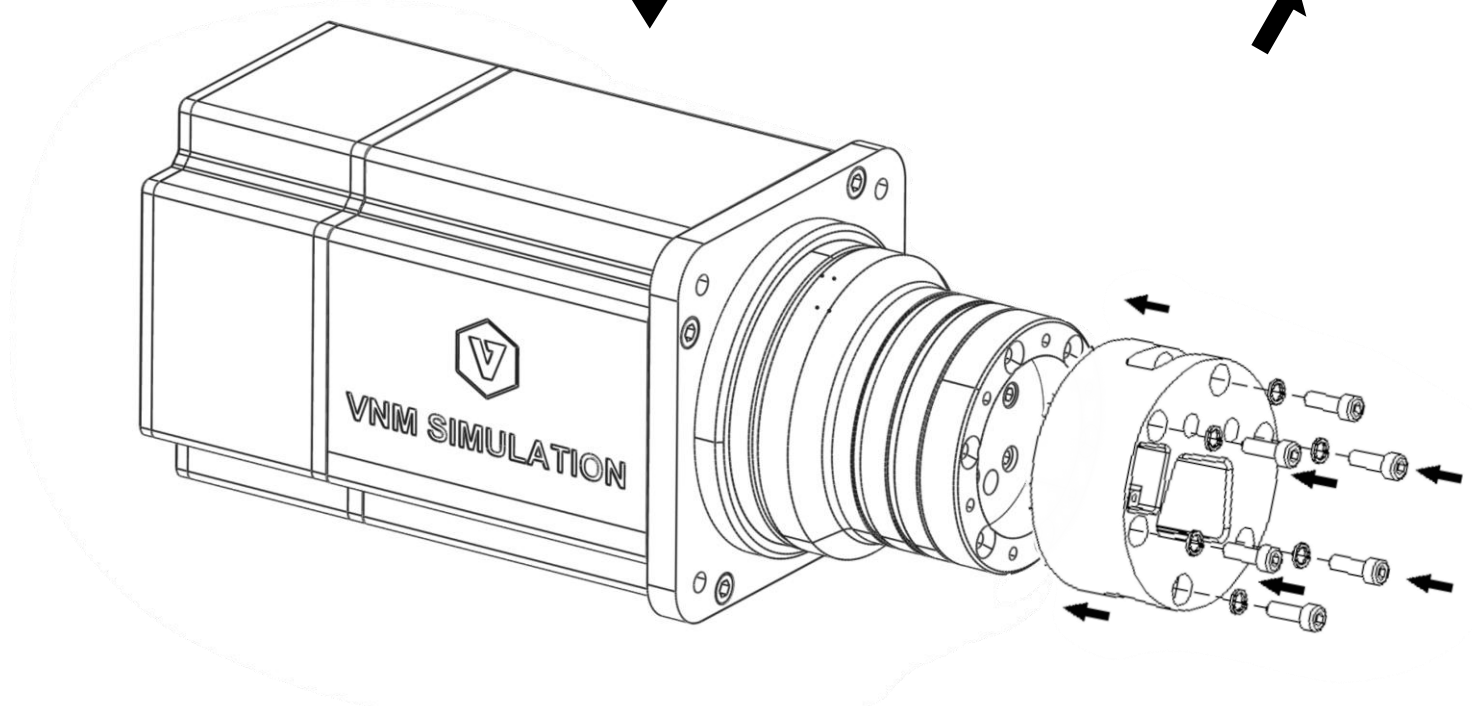
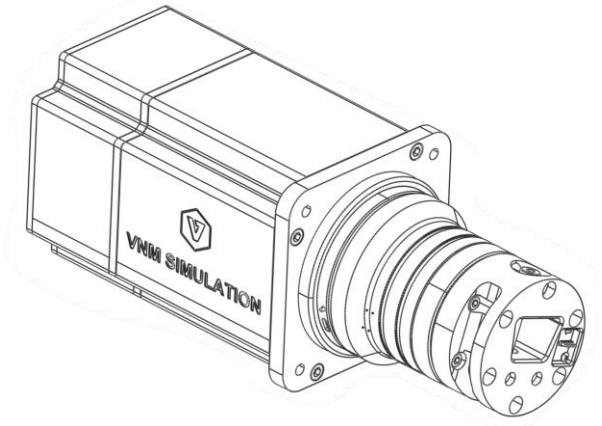
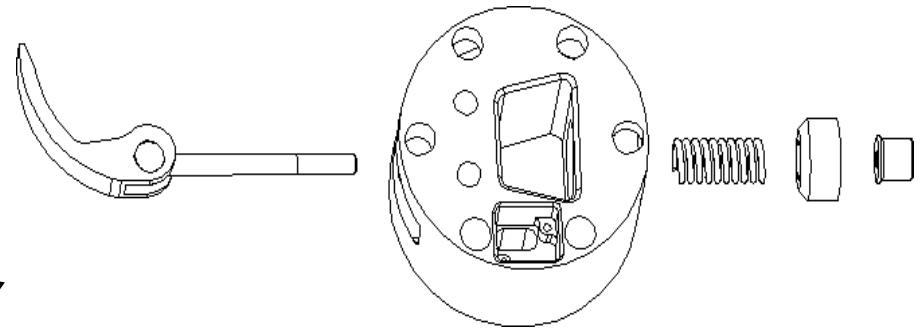
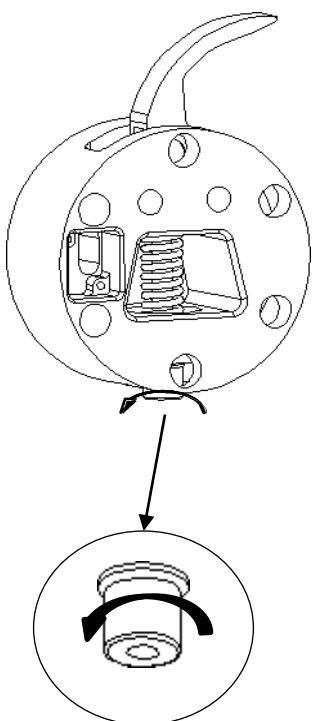

Install the six M5x16 screws together with the M5 Spring. Then fully tighten them.

*Install VNM Direct Drive and VNM QR Base side
(Method 2)*

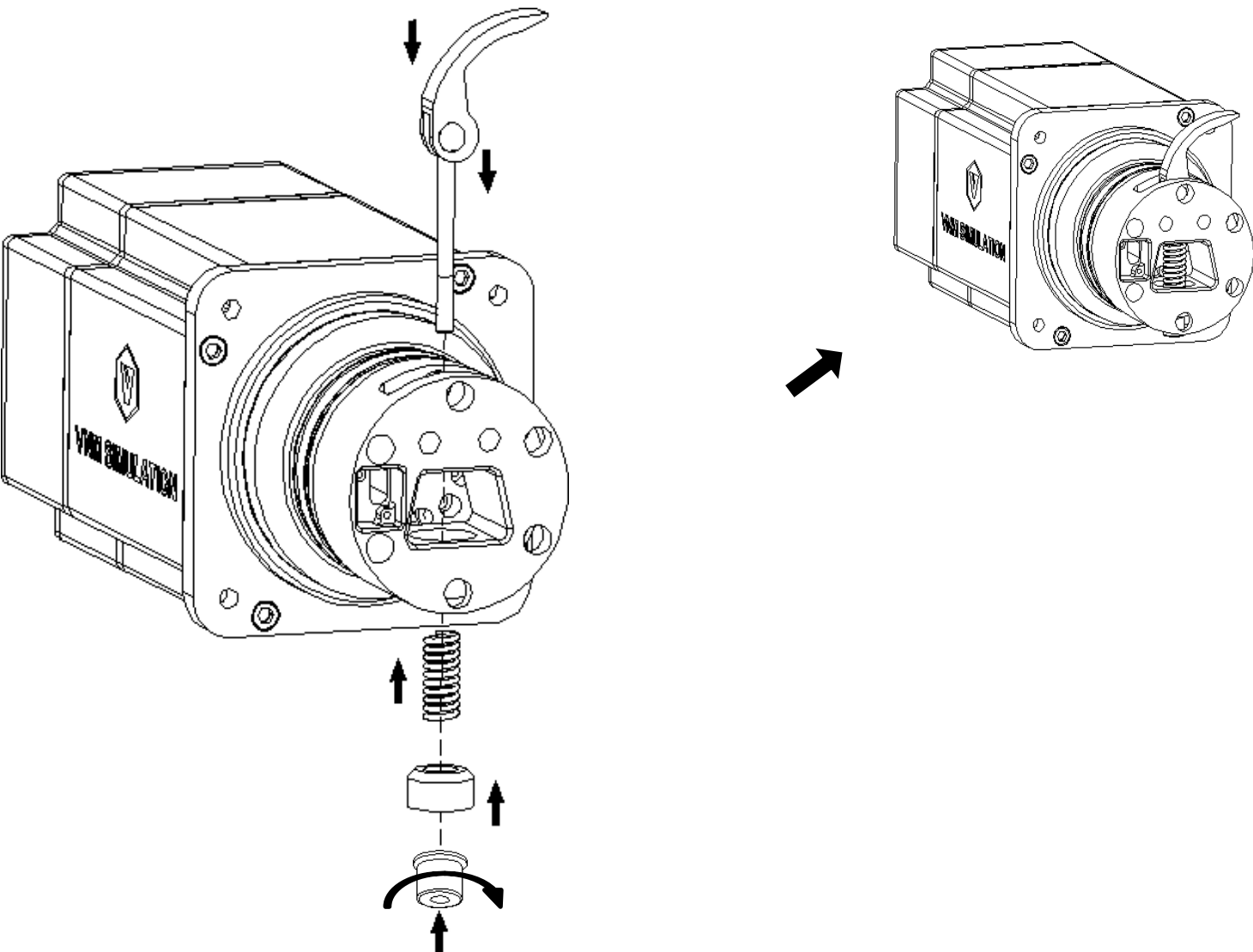

Install PCB Wheel side and QR wheel side

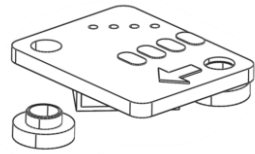

Manually press the IC3 plastic spacer into the PCB from the side without the arrow marking.

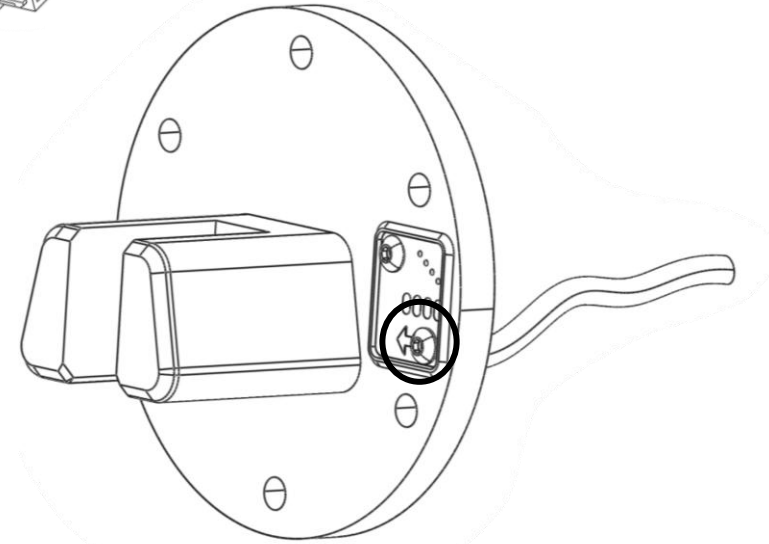
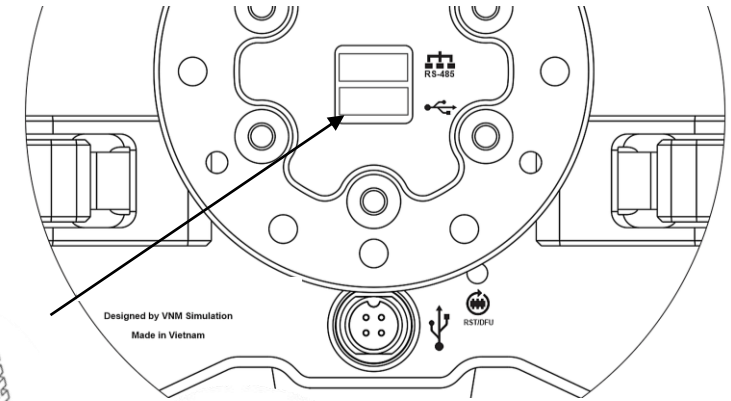
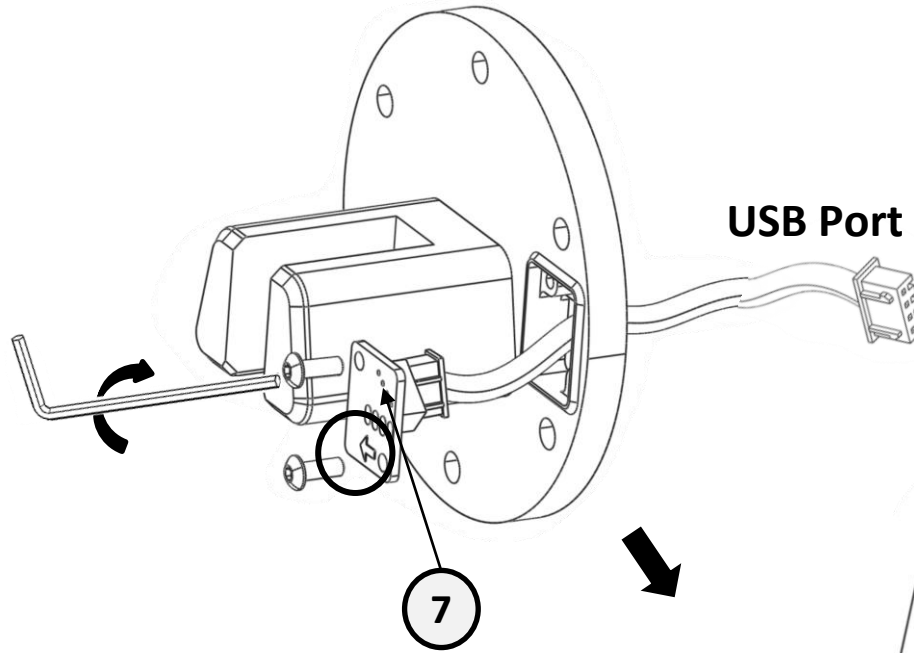
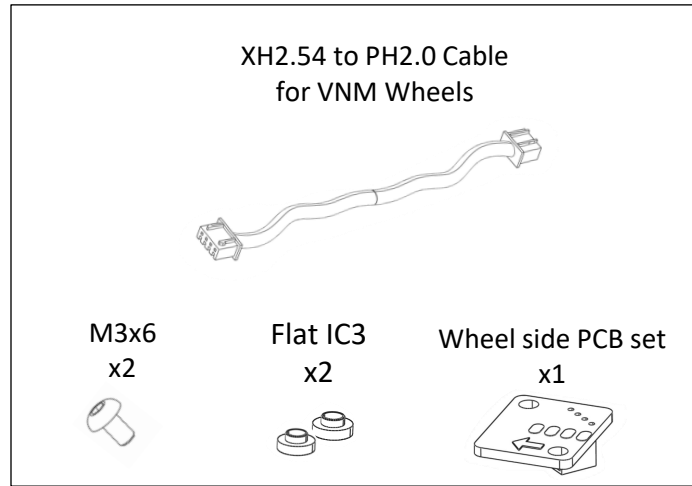
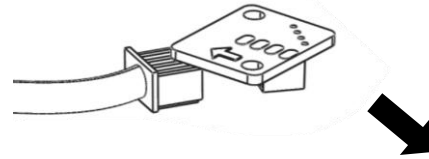

Tip: It is recommended to first connect the cable to the **USB** port on the wheel. Ensure that **the arrow** on the PCB is **oriented toward the center** of the wheel. Then connect the exposed PH2.0 header to the QR wheel-side PCB and tighten the two M3x6 screws to a moderate torque.

**Install VNM QR Wheel side for legacy GT Wheel
(without XH2.54 USB port)**

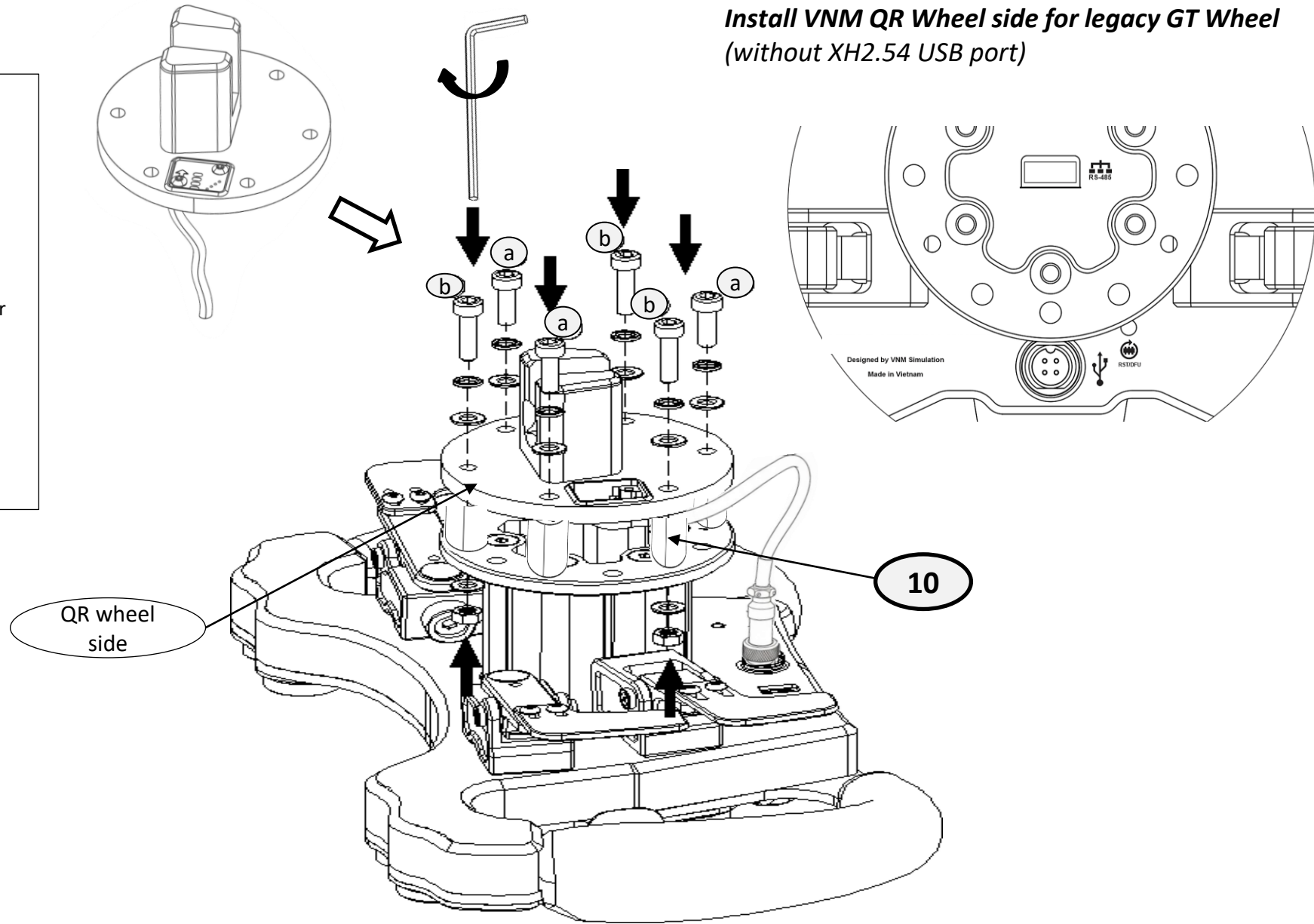
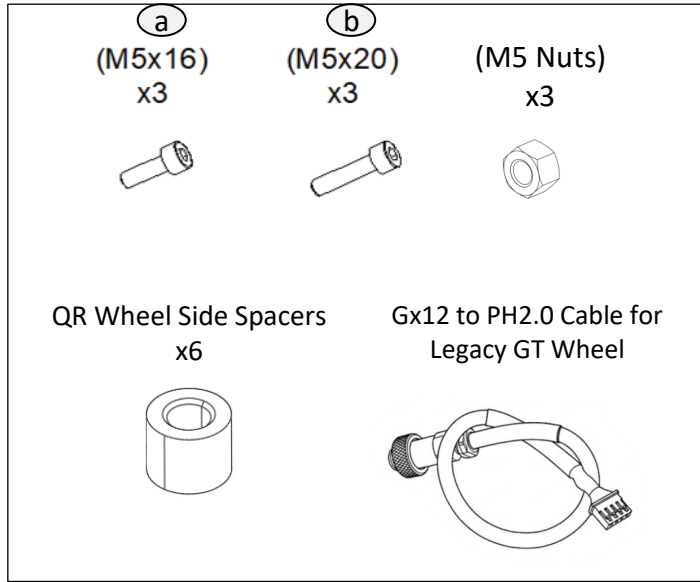

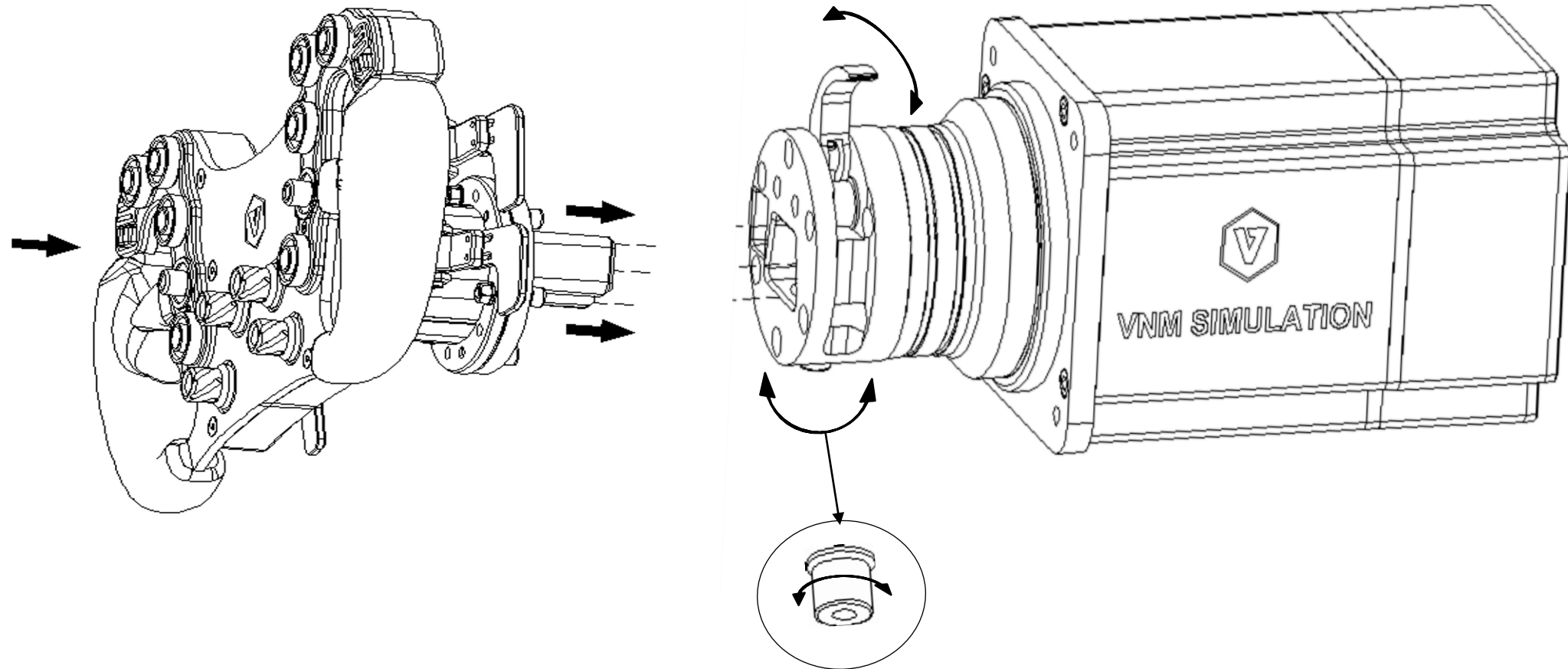

“Congratulations on completing your slipring assembly. If you have any questions or encounter any problems, please contact us for support!”

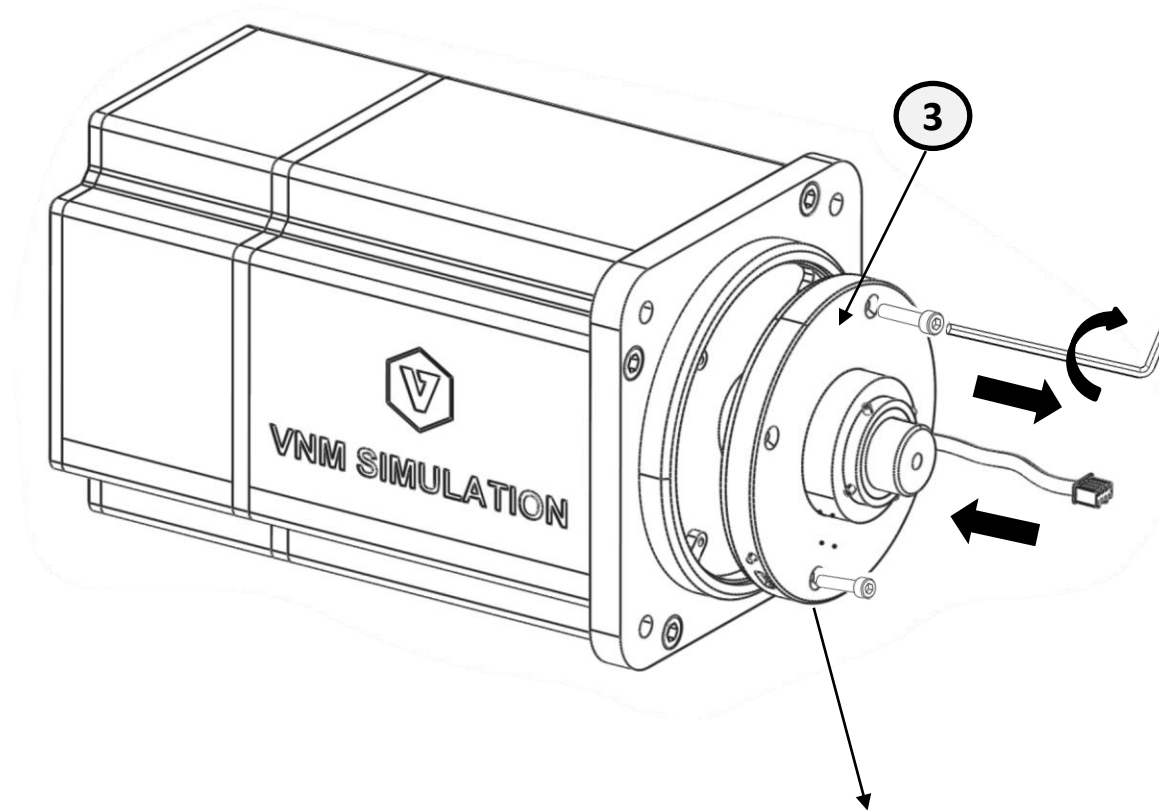
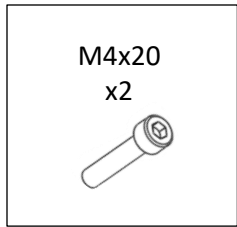

Tip: Install two M4 socket head cap screws into the two symmetrical threaded holes on part No. 3 to create **handholds** for easier installation and removal.

Disclaimer: Only lightly thread the screws into the VNM Slipping. They are for handling assistance only.